



USA: (704) 793 4319 UK: 01753 545554 WEB: [www.bmrs.net](http://www.bmrs.net)

## Adaptors

At Brown and Miller Racing Solutions we offer a comprehensive range of off-the-shelf lightweight adaptors which are shown in the following pages.

To complement this we are increasingly called upon to use our knowledge and expertise to custom design adaptor solutions, working in partnership with designers and specifiers for race teams and engine builders.

We manufacture anything from one-offs to multiple runs. As part of the design process we can also “print” a solid model.

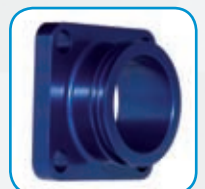



## Adaptors

### JIC Male / NPT Male (AN816)



Part number	Hose size	UNF Thread	NPT Thread	Matl.
AN816-3D	-03	3/8	1/8	A
AN816-4D	-04	7/16	1/8	A
AN816-4-4D	-04	7/16	1/4	A
AN816-6-2D	-06	9/16	1/8	A
AN816-6D	-06	9/16	1/4	A
AN816-6-6D	-06	9/16	3/8	A
AN816-6-8D	-06	9/16	1/2	A
AN816-7D	-08	3/4	1/4	A
AN816-8D	-08	3/4	3/8	A
AN816-10D	-10	7/8	1/2	A
AN816-10-12D	-10	7/8	3/4	A
AN816-12-8D	-12	1 1/16	1/2	A
AN816-12D	-12	1 1/16	3/4	A
AN816-12-16D	-12	1 1/16	1	A
AN816-16-12D	-16	1 5/16	3/4	A
AN816-16D	-16	1 5/16	1	A
AN816-20D	-20	1 5/8	1 1/4	A

### 45° Elbow JIC Male / NPT Male (AN823)



Part number	Hose size	UNF Thread	NPT Thread	Matl.
AN823-3C	-03	3/8	1/8	SS
AN823-3D	-03	3/8	1/8	A
AN823-4D	-04	7/16	1/8	A
AN823-4-4D	-04	7/16	1/4	A
AN823-4-6D	-04	7/16	3/8	A
AN823-6-2D	-06	9/16	1/8	A
AN823-6D	-06	9/16	1/4	A
AN823-6-6D	-06	9/16	3/8	A
AN823-6-8D	-06	9/16	1/2	A
AN823-7D	-08	3/4	1/4	A
AN823-8D	-08	3/4	3/8	A
AN823-8-8D	-08	3/4	1/2	A
AN823-10-6D	-10	7/8	3/8	A
AN823-10D	-10	7/8	1/2	A
AN823-10-12D	-10	7/8	3/4	A
AN823-12-8D	-12	1 1/16	1/2	A
AN823-12D	-12	1 1/16	3/4	A
AN823-12-16D	-12	1 1/16	1	A
AN823-16-12D	-16	1 5/16	3/4	A
AN823-16D	-16	1 5/16	1	A
AN823-20D	-20	1 5/8	1 1/4	A

### 90° Elbow JIC Male / NPT Male (AN822)



Part number	Hose size	UNF Thread	NPT Thread	Matl.
AN822-3C	-03	3/8	1/8	SS
AN822-3D	-03	3/8	1/8	A
AN822-4D	-04	7/16	1/8	A
AN822-4-4D	-04	7/16	1/4	A
AN822-4-6D	-04	7/16	3/8	A
AN822-6-2D	-06	9/16	1/8	A
AN822-6D	-06	9/16	1/4	A
AN822-6-6D	-06	9/16	3/8	A
AN822-6-8D	-06	9/16	1/2	A
AN822-7D	-08	3/4	1/4	A
AN822-8D	-08	3/4	3/8	A
AN822-8-8D	-08	3/4	1/2	A
AN822-10-6D	-10	7/8	3/8	A
AN822-10D	-10	7/8	1/2	A
AN822-10-12D	-10	7/8	3/4	A
AN822-12-8D	-12	1 1/16	1/2	A
AN822-12D	-12	1 1/16	3/4	A
AN822-12-16D	-12	1 1/16	1	A
AN822-16-12D	-16	1 5/16	3/4	A
AN822-16D	-16	1 5/16	1	A
AN822-20D	-20	1 5/8	1 1/4	A

### T Piece NPT on T (AN825)

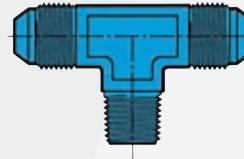

Part number	Hose size	UNF Thread	NPT Thread	Matl.
AN825-3D	-03	3/8	1/8	A
AN825-4D	-04	7/16	1/4	A
AN825-6D	-06	9/16	3/8	A
AN825-8D	-08	3/4	1/2	A
AN825-10D	-10	7/8	1/2	A
AN825-12	-12	1 1/16	3/4	A
AN825-16D	-16	1 5/16	1	A
AN825-20D	-20	1 5/8	1 1/4	A

### T Piece NPT on Run (AN826)

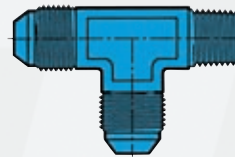

Part number	Hose size	UNF Thread	NPT Thread	Matl.
AN826-3D	-03	3/8	1/8	A
AN826-4D	-04	7/16	1/4	A
AN826-6D	-06	9/16	3/8	A
AN826-8D	-08	3/4	1/2	A
AN826-10D	-10	7/8	1/2	A
AN826-12D	-12	1 1/16	3/4	A
AN826-16D	-16	1 5/16	1	A
AN826-20D	-20	1 5/8	1 1/4	A



USA: (704) 793 4319 UK: 01753 545554 WEB: www.bmrs.net

## Adaptors

### Male / Male Equal (AN815)



Part number	Hose size	UNF Thread	Matl.
AN815-02J	-02	5/16	SS
AN815-03J	-03	3/8	SS
AN815-03D	-03	3/8	A
AN815-04J	-04	7/16	SS
AN815-04D	-04	7/16	A
AN815-06D	-06	9/16	A
AN815-08D	-08	3/4	A
AN815-10D	-10	7/8	A
AN815-12D	-12	1 1/16	A
AN815-16D	-16	1 5/16	A
AN815-20D	-20	1 5/8	A

### Male / Male Equal Bulkhead (AN832)

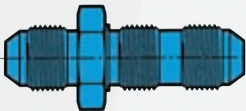

Part number	Hose size	UNF Thread	Matl.
AN832-2C	-02	5/16	SS
AN832-3C	-03	3/8	SS
AN832-3D	-03	3/8	A
AN832-4C	-04	7/16	SS
AN832-4D	-04	7/16	A
AN832-6D	-06	9/16	A
AN832-8D	-08	3/4	A
AN832-10D	-10	7/8	A
AN832-12D	-12	1 1/16	A
AN832-16D	-16	1 5/16	A
AN832-20D	-20	1 5/8	A

### 90° Elbow Male / Male Bulkhead (AN833)

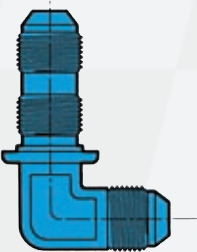

Part number	Hose size	UNF Thread	Matl.
AN833-3D	-03	3/8	A
AN833-4D	-04	7/16	A
AN833-6D	-06	9/16	A
AN833-8D	-08	3/4	A
AN833-10D	-10	7/8	A
AN833-12D	-12	1 1/16	A
AN833-16D	-16	1 5/16	A
AN833-20D	-20	1 5/8	A

### T Piece Bulkhead on T (AN834)

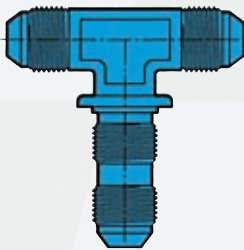

Part number	Hose size	UNF Thread	Matl.
AN834-3D	-03	3/8	A
AN834-4D	-04	7/16	A
AN834-6D	-06	9/16	A
AN834-8D	-08	3/4	A
AN834-10D	-10	7/8	A
AN834-12D	-12	1 1/16	A
AN834-16D	-16	1 5/16	A
AN834-20D	-20	1 5/8	A

### T Piece Equal (AN824)



Part number	Hose size	UNF Thread	Matl.
AN824-2C	-02	5/16	SS
AN824-3C	-03	3/8	SS
AN824-3D	-03	3/8	A
AN824-4C	-04	7/16	SS
AN824-4D	-04	7/16	A
AN824-6D	-06	9/16	A
AN824-8D	-08	3/4	A
AN824-10D	-10	7/8	A
AN824-12D	-12	1 1/16	A
AN824-16D	-16	1 5/16	A
AN824-20D	-20	1 5/8	A

### 45° Elbow Male / Male Bulkhead (AN837)

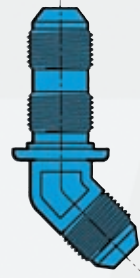

Part number	Hose size	UNF Thread	Matl.
AN837-3D	-03	3/8	A
AN837-4D	-04	7/16	A
AN837-6D	-06	9/16	A
AN837-8D	-08	3/4	A
AN837-10D	-10	7/8	A
AN837-12D	-12	1 1/16	A
AN837-16D	-16	1 5/16	A
AN837-20D	-20	1 5/8	A

### T Piece Bulkhead on Run (AN804)

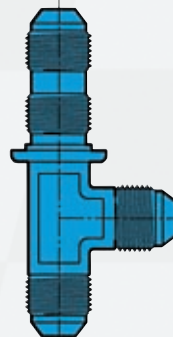

Part number	Hose size	UNF Thread	Matl.
AN804-3D	-03	3/8	A
AN804-4D	-04	7/16	A
AN804-6D	-06	9/16	A
AN804-8D	-08	3/4	A
AN804-10D	-10	7/8	A
AN804-12D	-12	1 1/16	A
AN804-16D	-16	1 5/16	A
AN804-20D	-20	1 5/8	A





## Adaptors

### Lock Nut (AN924)



Part number	Hose size	UNF Thread	Matl.
AN924-2C	-02	5/16	SS
AN924-3C	-03	3/8	SS
AN924-3D	-03	3/8	A
AN924-4C	-04	7/16	SS
AN924-4D	-04	7/16	A
AN924-6D	-06	9/16	A
AN924-8D	-08	3/4	A
AN924-10D	-10	7/8	A
AN924-12D	-12	1 1/16	A
AN924-16D	-16	1 5/16	A
AN924-20D	-20	1 5/8	A

### Coupler Female / Female (FCP)

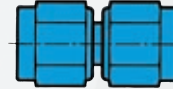

Part number	Hose size	UNF Thread	Matl.
FCP-4	-04	7/16	A
FCP-6	-06	9/16	A
FCP-8	-08	3/4	A
FCP-10	-10	7/8	A
FCP-12	-12	1 1/16	A
FCP-16	-16	1 5/16	A
FCP-20	-20	1 5/8	A

### Blanking Plug JIC Male (AN806)

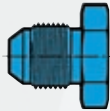

Part number	Hose size	UNF Thread	Matl.
AN806-2D	-02	5/16	A
AN806-3D	-03	3/8	A
AN806-4D	-04	7/16	A
AN806-6D	-06	9/16	A
AN806-8D	-08	3/4	A
AN806-10D	-10	7/8	A
AN806-12D	-12	1 1/16	A
AN806-16D	-16	1 5/16	A
AN806-20D	-20	1 5/8	A

### Blanking Plug Male (AN814)



Part number	Hose size	UNF Thread	Matl.
AN814-2D	-02	5/16	A
AN814-3D	-03	3/8	A
AN814-4D	-04	7/16	A
AN814-6D	-06	9/16	A
AN814-8D	-08	3/4	A
AN814-10D	-10	7/8	A
AN814-12D	-12	1 1/16	A
AN814-16D	-16	1 5/16	A
AN814-20D	-20	1 5/8	A

### Blanking Cap JIC Female (AN929)



Part number	Hose size	UNF Thread	Matl.
AN929-2D	-02	5/16	A
AN929-3D	-03	3/8	A
AN929-4D	-04	7/16	A
AN929-6D	-06	9/16	A
AN929-8D	-08	3/4	A
AN929-10D	-10	7/8	A
AN929-12D	-12	1 1/16	A
AN929-16D	-16	1 5/16	A
AN929-20D	-20	1 5/8	A

### Male / Male Unequal (AN919)

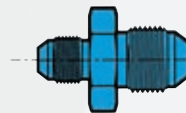

Part number	Hose size	UNF Thread	UNF Thread	Matl.
AN919-1C	-3 / -02	3/8	5/16	SS
AN919-2D	-4 / -03	7/16	3/8	A
AN919-5D	-6 / -03	9/16	3/8	A
AN919-6D	-6 / -04	9/16	7/16	A
AN919-10D	-8 / -04	3/4	7/16	A
AN919-12D	-8 / -06	3/4	9/16	A
AN919-14D	-10 / -06	7/8	9/16	A
AN919-15D	-10 / -08	7/8	3/4	A
AN919-18D	-12 / -06	1 1/16	9/16	A
AN919-19D	-12 / -08	1 1/16	3/4	A
AN919-20D	-12 / -10	1 1/16	7/8	A
AN919-22D	-16 / -10	1 5/16	7/8	A
AN919-23D	-16 / -12	1 5/16	1 1/16	A
AN919-25D	-20 / -12	1 5/8	1 1/16	A
AN919-26D	-20 / -16	1 5/8	1 5/16	A
AN919-27D	-24 / -16	1 7/8	1 5/16	A
AN919-28D	-24 / -20	1 7/8	1 5/8	A

## Adaptors

### T Piece Equal - Female on Leg (CPL-824)

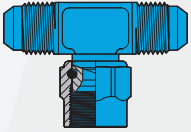

Part number	Hose size	UNF Thread	Matl.
CPL-824-03D	-03	3/8	A
CPL-824-04D	-04	7/16	A
CPL-824-06D	-06	9/16	A
CPL-824-08D	-08	3/4	A
CPL-824-10D	-10	7/8	A
CPL-824-12D	-12	1 1/16	A
CPL-824-16D	-16	1 5/16	A

### T Piece Equal - Female on Run (CPL-826)

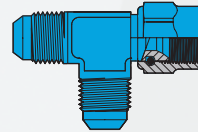

Part number	Hose size	UNF Thread	Matl.
CPL-826-03D	-03	3/8	A
CPL-826-04D	-04	7/16	A
CPL-826-06D	-06	9/16	A
CPL-826-08D	-08	3/4	A
CPL-826-10D	-10	7/8	A
CPL-826-12D	-12	1 1/16	A
CPL-826-16D	-16	1 5/16	A

### T Piece Unequal

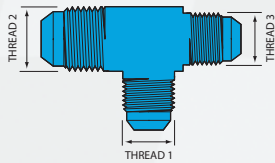

Part number	Thread 1	Thread 2	Thread 3	Matl.
18-0050-04-3	7/16	3/8	3/8	A

### T Piece Unequal - Female on Leg

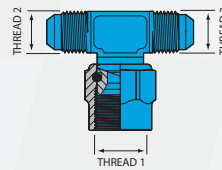

Part number	Thread 1	Thread 2	Thread 3	Matl.
18-0138-06-3	9/16	3/8	3/8	A
18-0138-06-7	9/16	3/8	3/8	SS

### JIC Male to JIC Female Step Down

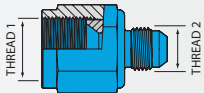

Part number	Thread 1	Thread 2	Matl.
AN950-04-03	7/16 x 20	3/8 x 24	A
AN950-06-03	9/16 x 18	3/8 x 24	A
AN950-06-04	9/16 x 18	7/16 x 20	A
AN950-08-04	3/4 x 16	7/16 x 20	A
AN950-08-06	3/4 x 16	9/16 x 18	A
AN950-10-06	7/8 x 14	9/16 x 18	A
AN950-10-08	7/8 x 14	3/4 x 16	A
AN950-12-08	1 1/16 x 12	3/4 x 16	A
AN950-12-10	1 1/16 x 12	7/8 x 14	A
AN950-16-12	1 5/16 x 12	1 1/16 x 12	A
AN950-20-16	1 5/8 x 12	1 5/16 x 12	A

### JIC Male to JIC Female Step Up

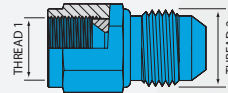

Part number	Thread 1	Thread 2	Matl.
AN951-03-04	3/8 x 24	7/16 x 20	A
AN951-04-06	7/16 x 20	9/16 x 18	A
AN951-06-08	9/16 x 18	3/4 x 16	A
AN951-08-10	3/4 x 16	7/8 x 14	A
AN951-10-12	7/8 x 14	1 1/16 x 12	A
AN951-12-16	1 1/16 x 12	1 5/16 x 12	A



## Adaptors

### JIC (AN) Male to Metric Male (Concave)

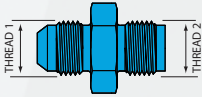

Fitting part number		Thread 1	Thread 2	Fitting part number		Thread 1	Thread 2
Aluminium	Stainless steel			Aluminium	Stainless steel		
	306-02-31C	5/16 x 24	M10 x 1.00	306-10-M16D		7/8 x 14	M16 X 1.50
	306-02-32C	5/16 x 24	M10 x 1.25	306-10-M18D		7/8 x 14	M18 x 1.50
306-03-31D	306-03-31C	3/8 x 24	M10 x 1.00	306-10-M20D		7/8 x 14	M20 x 1.50
306-03-32D	306-03-32C	3/8 x 24	M10 x 1.25	306-10-M22D		7/8 x 14	M22 x 1.50
306-03-35D		3/8 x 24	M10 x 1.50	306-10-M24D		7/8 x 14	M24 x 1.50
306-03-M12D		3/8 x 24	M12 x 1.50	306-10-M26D		7/8 x 14	M26 x 1.50
306-03-M121D	306-03-M121C	3/8 x 24	M12 x 1.00	306-10-M30D		7/8 x 14	M30 x 1.50
306-03-M14D		3/8 x 24	M14 x 1.50				
306-03-M16D		3/8 x 24	M16 x 1.50	306-12-M18D		1 1/16 x 12	M18 x 1.50
				306-12-M20D		1 1/16 x 12	M20 x 1.50
306-04-31D		7/16 x 20	M10 x 1.00	306-12-M22D		1 1/16 x 12	M22 x 1.50
306-04-32D		7/16 x 20	M10 x 1.25	306-12-M24D		1 1/16 x 12	M24 x 1.50
306-04-M12D		7/16 x 20	M12 x 1.50	306-12-M26D		1 1/16 x 12	M26 x 1.50
306-04-M121D		7/16 x 20	M12 x 1.00	306-12-M30D		1 1/16 x 12	M30 x 1.50
306-04-M14D		7/16 x 20	M14 x 1.50				
306-04-M16D		7/16 x 20	M16 x 1.50	306-16-M22D		1 5/16 x 12	M22 x 1.50
306-04-M20D		7/16 x 20	M20 x 1.50	306-16-M24D		1 5/16 x 12	M24 x 1.50
				306-16-M26D		1 5/16 x 12	M26 x 1.50
306-06-31D		9/16 x 18	M10 x 1.00	306-16-M30D		1 5/16 x 12	M30 x 1.50
306-06-32D		9/16 x 18	M10 x 1.25				
306-06-M121D		9/16 x 18	M12 x 1.00				
306-06-M12D		9/16 x 18	M12 x 1.50				
306-06-M14D		9/16 x 18	M14 x 1.50				
306-06-M16D		9/16 x 18	M16 X 1.50				
306-06-M18D		9/16 x 18	M18 x 1.50				
306-06-M20D		9/16 x 18	M20 x 1.50				
306-06-M22D		9/16 x 18	M22 x 1.50				
306-06-M24D		9/16 x 18	M24 x 1.50				
306-08-M12D		3/4 x 16	M12 x 1.50				
306-08-M14D		3/4 x 16	M14 x 1.50				
306-08-M16D		3/4 x 16	M16 X 1.50				
306-08-M18D		3/4 x 16	M18 x 1.50				
306-08-M20D		3/4 x 16	M20 x 1.50				
306-08-M22D		3/4 x 16	M22 x 1.50				
306-08-M24D		3/4 x 16	M24 x 1.50				
306-08-M26D		3/4 x 16	M26 x 1.50				



USA: (704) 793 4319 UK: 01753 545554 WEB: www.bmrs.net

## Adaptors

### Adaptor-NPT Female to JIC Male

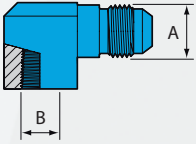

Part number	A - UNF Thread		B - NPT Thread			Matl.
	ins	mm	ins	mm	JIC Male	
21-0010-04-3	7/16 x 20	-	1/8	-	-04	A

### ORB Male to Wiggins Male

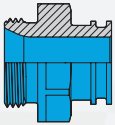

Part Number	Male Thread	Wiggins Male
18-0154-06-08-3	9/16 x 18	-08
18-0154-08-3	3/4 x 16	-08
18-0154-08-10-3	3/4 x 16	-10
18-0154-10-3	7/8 x 14	-10
18-0154-10-12-3	7/8 x 14	-12
18-0154-12-3	1 1/16 x 12	-12
18-0154-12-16-3	1 1/16 x 12	-16
18-0154-16-3	1 5/16 x 12	-16
18-0154-20-3	1 5/8 x 12	-20

### Auto Verdi and FWRC Oil Pumps

Part Number	Male Thread	Wiggins Male
18-0217-12-3	1 1/8 x 20	-12

### Setrab Coolers

Part Number	Male Thread	Wiggins Male
18-0175-12-3	M22 x 1.5	-12

### ORB Male to JIC Male

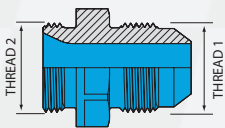

Part number	Thread 1 JIC Male	Hose size	Thread 2 ORB Male
18-0288-04-3	7/16 x 20	-04	7/16 x 20
18-0288-06-3	9/16 x 18	-06	9/16 x 18
18-0288-08-3	3/4 x 16	-08	3/4 x 16
18-0288-10-3	7/8 x 14	-10	7/8 x 14
18-0288-10-12-3	1 1/16 x 12	-12	7/8 x 14
18-0288-12-3	1 1/16 x 12	-12	1 1/16 x 12
18-0288-12-16-3	1 5/16 x 12	-16	1 1/16 x 12
18-0288-16-3	1 5/16 x 12	-16	1 5/16 x 12
18-0288-20-3	1 5/8 x 12	-20	1 5/8 x 12



USA: (704) 793 4319 UK: 01753 545554 WEB: www.bmrs.net

## Adaptors

### Banjo to JIC Male

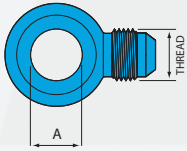

Fitting part number	Thread		Bolt size 'A'	
	Stainless steel	Aluminium	ins	mm
BJA-02-03-7			3/8	10
BJA-03-7	BJA-03-3		3/8	10
BJA-04-7	BJA-04-3		7/16	
	BJA-04-M12-3			12
	BJA-04-M14-3			14
	BJA-06-3		9/16	
	BJA-06-M12-3			12
	BJA-06-M14-3			14
	BJA-06-M16-3			16
	BJA-08-3		3/4	
	BJA-08-M14-3			14
	BJA-08-M16-3			16
	BJA-08-M18-3			18

### Banjo Bolt

#### Banjo Bolt

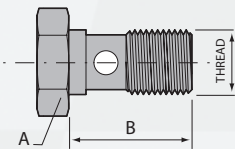

Part number	Thread			A	B			
	Stainless steel	Aluminium	Plated steel		ins	mm	ins	mm
BJB-02-1-7	-	-	BJB-02-1-P	5/16 x 24	1/2	12.7	0.79	20.0
-	-	-	BJB-02-1-P-L	5/16 x 24	1/2	12.7	0.98	25.0
BJB-02-2-7	BJB-02-2-3		BJB-02-2-P	M8 x 1.00	1/2	12.7	0.76	19.0
BJB-02-3-7	-		-	M8 x 1.25	1/2	12.7	0.79	20.0
BJB-03-1-7	BJB-03-1-3		BJB-03-1-P	3/8 x 24	9/16	14.3	0.79	20.0
BJB-03-1-7-L	BJB-03-1-3-L		BJB-03-1-P-L	3/8 x 24	9/16	14.3	0.98	25.0
BJB-03-1-7S	-		BJB-03-1-PS	3/8 x 24	9/16	14.3	0.71	18.0
BJB-03-2-7	BJB-03-2-3		BJB-03-2-P	M10 x 1.00	9/16	14.3	0.79	20.0
BJB-03-2-7-L	BJB-03-2-3-L		BJB-03-2-P-L	M10 x 1.00	9/16	14.3	0.98	25.0
BJB-03-2-7S	-		-	M10 x 1.00	9/16	14.3	0.71	18.0
BJB-03-3-7	BJB-03-3-3		BJB-03-3-P	M10 x 1.25	9/16	14.3	0.79	20.0
BJB-03-3-7-L	BJB-03-3-3-L		BJB-03-3-P-L	M10 x 1.25	9/16	14.3	0.98	25.0
BJB-04-7	BJB-04-3		BJB-04-P	7/16 x 20	5/8	15.9	1.06	27.0
-	BJB-04-M12-3		BJB-04-M12-P	M12 x 1.25	5/8	15.9	1.06	27.0
-	BJB-06-3		-	9/16 x 18	7/8	22.2	1.30	33.0
-	BJB-06-M14-3		-	M14 x 1.50	7/8	22.2	1.30	33.0

#### Banjo Bolt with wire locking holes

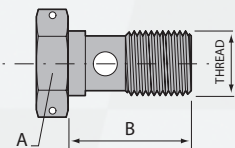

Part number	Thread size	A		B	
		ins	mm	ins	mm
BJB-03-1-7S-W	3/8 x 24	9/16	14.3	0.71	18.0
BJB-03-2-7S-W	M10 x 1.00	9/16	14.3	0.71	18.0





USA: (704) 793 4319 UK: 01753 545554 WEB: www.bmrs.net

## Adaptors

### Weld on JIC (AN) Male

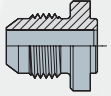

Fitting part number		Hose size	Thread size
Aluminium	Stainless steel		
WO-06-JJ		-06	9/16 x 18
WO-08-JJ		-08	3/4 x 16
WO-10-JJ		-10	7/8 x 14
WO-12-JJ		-12	1 1/16 x 12
WO-16-JJ		-16	1 5/16 x 12
WO-20-JJ		-20	1 5/8 x 12

### Weld on ORB Female

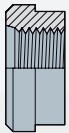

Fitting part number		Hose size	Thread size
Aluminium	Stainless steel		
WO-06-ORB-FJ		-06	9/16 x 18
WO-08-ORB-FJ		-08	3/4 x 16
WO-10-ORB-FJ		-10	7/8 x 14
WO-12-ORB-FJ		-12	1 1/16 x 12
WO-16-ORB-FJ		-16	1 5/16 x 12
WO-20-ORB-FJ		-20	1 5/8 x 12

### Weld on NPT Female

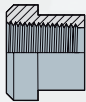

Fitting part number		Hose size	Thread size NPT
Aluminium	Stainless steel		
WO-03-TJ		-03	1/8 x 27
WO-04-TJ		-04	1/4 x 18
WO-06-TJ		-06	3/8 x 18
WO-08-TJ		-08	1/2 x 14
WO-12-TJ		-12	3/4 x 14
WO-16-TJ		-16	1 x 11.5
WO-20-TJ		-20	1 1/4 x 11.5

### Weld on Flareless Male

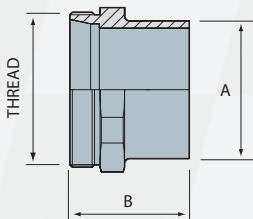

Fitting part number		Hose size	Thread size	A		B	
Aluminium	Stainless steel			ins	mm	ins	mm
TF-0021-24-J		-24	1 13/16 x 12	1.58	40.13	1.85	47.00
TF-0021-28-J		-28	2 1/8 x 12	1.83	46.50	1.85	47.00
TF-0021-32-J		-32	2 3/8 x 12	2.12	53.78	1.85	47.00



USA: (704) 793 4319 UK: 01753 545554 WEB: www.bmrs.net

## Custom Adaptors

**-12 Bulkhead JIC Male to  
-12 Wiggins Male**



Fitting part no.  
18-0182-12-3

**-16 Bulkhead JIC Male to  
-16 Wiggins Male**



Fitting part no.  
18-0182-16-3

**Swivel Banjo -8 JIC Male to  
7/8 UNF Bolt WRC Pump**



Fitting part no.  
18-0232-08-3

**Power Steering (Saginaw)  
M16 Male to -08 Wiggins Male**



Fitting part no.  
18-0238-06-7

**-03 JIC Fixed Female to  
M10 x 1.0 Fixed Female**



Fitting part no.  
18-0255-03-7

**Banjo Bolt 7/16 UNF with  
-03 JIC Male Takeoff**



Fitting part no.  
19-0034-04-7

**4 Way Cross Piece  
-03 JIC Male**



Fitting part no.  
18-0261-03-7

**4 Way Cross Piece  
-03 JIC Males, 1/8 NPT Female**



Fitting part no.  
18-0185-03-7